





CL.1 Wall valve clockwise closing cold 1/2" - Chrome

CL.1

36 627 706

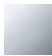

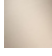
- with CASCADE structure
- rosette 60 x 60 mm
- with cold marking
- head part with cut-to-length spindle and sleeve

| | | |
|---|-------------------------------|---------------|
|  | Chrome | 36 627 706-00 |
|  | Brushed Platinum | 36 627 706-06 |
|  | Dark Chrome | 36 627 706-19 |
|  | Brushed Champagne (22kt Gold) | 36 627 706-46 |
|  | Champagne (22kt Gold) | 36 627 706-47 |
|  | Brushed Dark Platinum | 36 627 706-99 |

Required miscellaneous



- Wall valve 1/2" -** 35 607 970 90
- max. recess depth 150 mm
 - min. recess depth 105 mm

36 627 706

mm [inches]

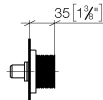
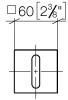

Certificates

DVGW_DW-
6501DN0116.

IAPMO_4976 (1).

LGA_29931.

WRAS_2010066.

LGA_29932.

36 627 706

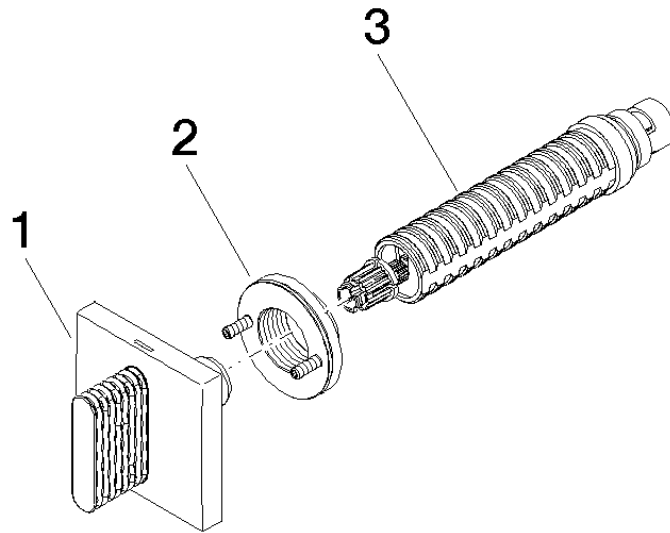

Spare parts list

| No. | Item Number | Name | Quantity used | Delivery time |
|-----|--------------------|-----------------|---------------|---------------|
| 1 | 90 20 70 053 02-00 | handle (cold) | 1 | 10 |
| 2 | 90 21 02 108 00 90 | disc | 1 | 2 |
| 3 | 90 90 03 143 00 90 | top | 1 | 2 |